

# JACKODUR®

Thermal insulation for structural use.





Inverted roof with JACKODUR®



Exterior insulation behind panelling with JACKODUR®



Insulation under screed with JACKODUR®



Thermal bridge insulation with JACKODUR® Gefiniert



Perimeter insulation with JACKODUR®

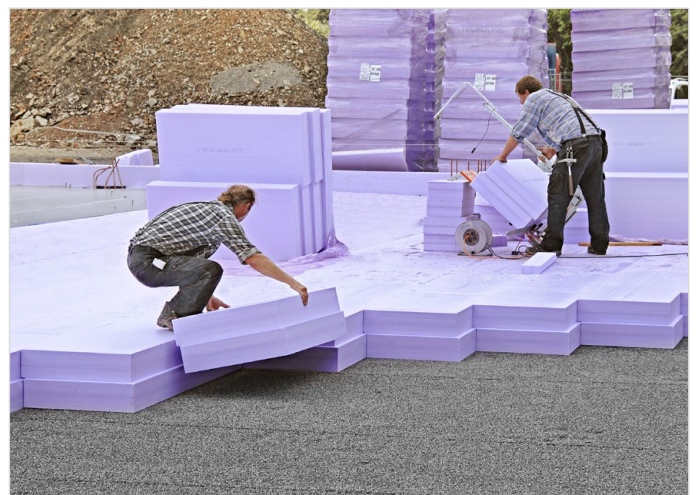

Perimeter of base-plate and foundations with JACKODUR®



JACKODUR®

Thermal insulation for structural use.

## XPS thermal insulation by JACKON Insulation

JACKODUR® is a top quality thermal insulation material made of extruded polystyrene foam – highly compression proof, dimensionally stable, and moisture and rot resistant. JACKODUR® thermal insulation is available in a wide range of thickness and edge profiles, and with smooth or textured surfaces. The lambda values of the entire range of JACKODUR® XPS products are very low, even and especially with larger thicknesses. We recommend only ever laying one layer to take the best possible structural advantage of this in all applications.



Water repellent



Superb thermal insulation properties  
from  $\lambda_D=0,027$  W/(m·K)



Suitable for use in groundwater



Resistant to frost/thaw changes



Highly compression proof  
≥ 300, 500, 700 kPa



Complete with  
national technical approval



Insulation thicknesses from 20 - 320 mm

## Table of Contents

### Thermal insulation

Application range	02
Plus 300 Standard SF	04
Plus 300 Gefiniert GL	04
KF 300 Standard SF	05
KF 300 Standard GL	05
KF 300 Gefiniert GL	06
KF 300 Standard NF	06
KF 500 Standard SF	07
KF 700 Standard SF	07

### Cold bridge insulation

Foundation shuttering	08
Rendering edging strips	08
Insulation shuttering JDS	09
Insulation shuttering Plus	09
Insulation Strip	10
Angle fillet	10
Cavity tray insulation	10

### Accessories

Perimeter adhesive foam	11
Assembly adhesive	11
Filter layer WA	11

### Insulation system for floor plates

JACKODUR® Atlas	12-13
JACKODUR® Technical data	14-15

Valid from March 2020

This document replaces all previous versions and editions. All deliveries are governed exclusively by our General Terms and Conditions of Sale and Supply and by our Installation Instructions, in both cases as amended at the time of ordering (available on the internet at [www.jackon-insulation.com](http://www.jackon-insulation.com)). All prices apply for entire packaging units and are exclusive of statutory VAT. Please observe our minimum order value. Deliveries exclude unloading.

# Thermal insulation

## JACKODUR® Plus 300 Standard SF

- High-performance insulation with superb insulating properties  $\lambda_D = 0.027 \text{ W/(m}\cdot\text{K)}$
- Boards with 15 mm shiplap allround for insulating perimeters, flat roofs, beneath screed, etc.
- Smooth, extrusion-compressed surface
- Compressive strength 300 kPa
- Format 1265 x 615 mm, covering area 1250 x 600 mm = 0.75 m<sup>2</sup>

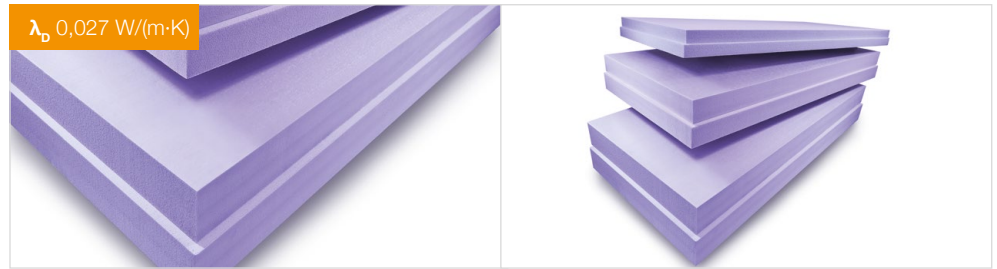

Art. no.	EAN code	Thickness mm	Boards per pack	Packs per pallet	m <sup>2</sup> /pack
4508142*	40 25345 07005 7	50	8	12	6,00
4508143*	40 25345 07006 4	60	7	12	5,25
4508144*	40 25345 07007 1	80	5	12	3,75
4508145	40 25345 07008 8	100	4	12	3,00
4508300	40 25345 07120 7	120	3	14	2,25
4508301	40 25345 07121 4	140	3	12	2,25
4508302	40 25345 07122 1	160	3	10	2,25
4508303	40 25345 07123 8	180	2	14	1,50
4508304	40 25345 07124 5	200	2	12	1,50
4509133*	40 25345 07745 2	220	2	12	1,50
4509134*	40 25345 07746 9	240	2	10	1,50
4516243*	40 2534511899 5	260	2	10	0,75
4516244*	40 2534511900 8	280	2	10	0,75
4516239*	40 2534511894 0	300	1	18	0,75
4516238*	40 2534511895 7	320	1	16	0,75

\* on request

## JACKODUR® Plus 300 Gefiniert GL

- High-performance insulation with superb insulation properties  $\lambda_D = 0.027 \text{ W/(m}\cdot\text{K)}$
- Structured extrusion-compressed surface for use under rendering or in cold stores and as expendable shuttering
- For use as render base, plinth insulation, concealed formwork for initial concrete application, and thermal bridge insulation
- Boards with smooth edges (GL)
- Tensile strength perpendicular to board plane: 200 kPa
- Format 1250 x 600 mm
- Compressive strength 300 kPa



Art. no.	EAN code	Thickness mm	Boards per pack	Packs per pallet	m <sup>2</sup> /pack
4510539*	40 25345 08669 0	50	8	12	6,00
4510540*	40 25345 08670 6	60	7	12	5,25
4510541	40 25345 08671 3	80	5	12	3,75
4510542	40 25345 08672 0	100	4	12	3,00
4510543	40 25345 08673 7	120	3	14	2,25
4510544*	40 25345 08674 4	140	3	12	2,25
4510545*	40 25345 08675 1	160	3	10	2,25
4510546*	40 25345 08676 8	180	2	14	1,50
4510547*	40 25345 08677 5	200	2	12	1,50

\* on request

# Thermal insulation



## JACKODUR® KF 300 Standard SF

Art. no.	EAN code	Thickness mm	Boards per pack	Packs per pallet	m <sup>2</sup> / pack
4500650	40 25345 00650 6	30	14	12	10,50
4500652	40 25345 00652 0	40	10	12	7,50
4500654	40 25345 00654 4	50	8	12	6,00
4500656	40 25345 00656 8	60	7	12	5,25
4501136	40 25345 01136 4	80	5	12	3,75
4502549	40 25345 02549 1	100	4	12	3,00
4502550	40 25345 02550 7	120	3	14	2,25

- Boards with 15 mm shiplap all-round
- For insulating perimeters, flat roofs, beneath screed, etc.
- Square, extrusion-compressed surface
- Compressive strength 300 kPa
- Format 1265 x 615 mm, covering area 1250 x 600 mm = 0.75 m<sup>2</sup>

4502551	40 25345 02551 4	140	3	12	2,25
4504072	40 25345 04072 2	160	3	10	2,25
4502553	40 25345 02553 8	180	2	14	1,50
4502554	40 25345 02554 5	200	2	12	1,50
4502968	40 25345 02968 0	220	2	12	1,50
4502969	40 25345 02969 7	240	2	10	1,50
4516240*	40 2534511896 4	260	2	10	0,75
4516247*	40 2534511903 9	280	2	10	1,50
4516232*	40 2534511888 9	300	1	18	0,75
4516233*	40 2534511889 6	320	1	16	0,75

\* on request



## JACKODUR® KF 300 Standard GL

Art. no.	EAN code	Thickness mm	Boards per pack	Packs per pallet	m <sup>2</sup> / pack
4500640 <sup>1</sup>	40 25345 00640 7	20	20	12	15,00
4500642*	40 25345 00642 1	30	14	12	10,50
4500644*	40 25345 00644 5	40	10	12	7,50
4500646*	40 25345 00646 9	50	8	12	6,00
4500648*	40 25345 00648 3	60	7	12	5,25
4501199*	40 25345 01199 9	80	5	12	3,75
4502568	40 25345 02568 2	100	4	12	3,00
4502569*	40 25345 02569 9	120	3	14	2,25

- Extrusion-compressed surface for floors, screed, multi-layer core insulation etc.
- Format 1250 x 600 mm
- Compressive strength 300 kPa
- Boards with smooth edges (GL)

4502570*	40 25345 02570 5	140	3	12	2,25
4504074*	40 25345 04074 6	160	3	10	2,25
4502572*	40 25345 02572 9	180	2	14	1,50
4503007*	40 25345 03007 5	200	2	12	1,50
4503008*	40 25345 03008 2	220	2	12	1,50
4503009*	40 25345 03009 9	240	2	10	1,50

\* on request

<sup>1</sup> compressive strength 200 kPa

# Thermal insulation

## JACKODUR® KF 300 Gefiniert GL

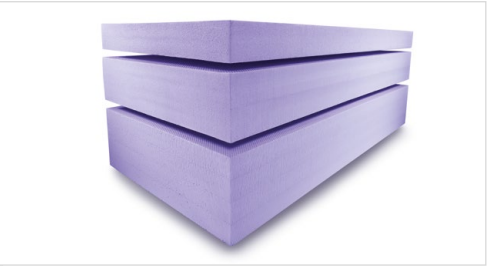
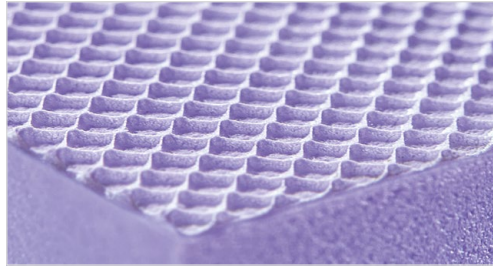

- Structured extrusion-compressed surface for use under rendering or in cold stores and as expendable shuttering
- For use as render base, plinth insulation, concealed formwork for initial concrete application, and thermal bridge insulation
- Boards with square edges (GL)
- Tensile strength perpendicular to board plane: 200 kPa
- Format 1250 x 600 mm
- Compressive strength 300 kPa

Art. no.	EAN code	Thickness mm	Boards per pack	Packs per pallet	m <sup>2</sup> /pack
4500622 <sup>1</sup>	40 25345 00622 3	20	20	12	15,00
4500624	40 25345 00624 7	30	14	12	10,50
4500626	40 25345 00626 1	40	10	12	7,50
4500628	40 25345 00628 5	50	8	12	6,00
4500630	40 25345 00630 8	60	7	12	5,25
4501137	40 25345 01137 1	80	5	12	3,75
4502556	40 25345 02556 9	100	4	12	3,00
4502557	40 25345 02557 6	120	3	14	2,25

4502558	40 25345 02558 3	140	3	12	2,25
4504073	40 25345 04073 9	160	3	10	2,25
4502560	40 25345 02560 6	180	2	14	1,50
4502561	40 25345 02561 3	200	2	12	1,50
4503014*	40 25345 03014 3	220	2	12	1,50
4503015*	40 25345 03015 0	240	2	10	1,50
4516433*	40 25345 11960 2	260	2	10	0,75
4516434*	40 25345 11961 9	280	2	10	0,75
4516435*	40 25345 11962 6	300	1	18	0,75
4516436*	40 25345 11963 3	320	1	16	0,75

\* on request

<sup>1</sup> compressive strength 200 kPa

## JACKODUR® KF 300 Standard NF

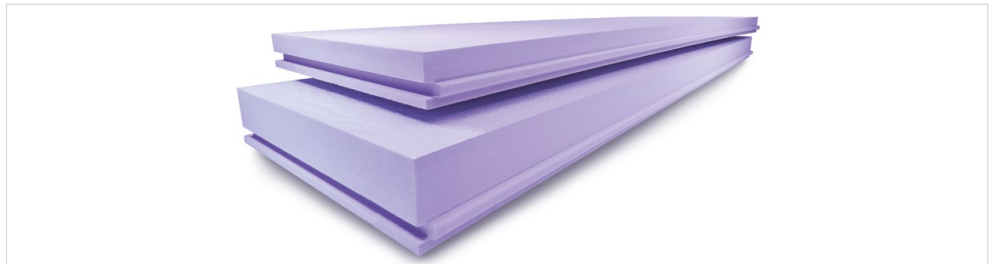

- Tongue and groove joint e.g. for pitched roofs (on rafters) etc.
- Extrusion-compressed surface
- Compressive strength 300 kPa
- Covering area  
2500 x 600 mm = 1.5 m<sup>2</sup>

Art. no.	EAN code	Thickness mm	Boards per pack	Packs per pallet	m <sup>2</sup> /Pack
4501579	40 25345 01579 9	40	10	12	15,00
4501580	40 25345 01580 5	50	8	12	12,00
4501581	40 25345 01581 2	60	7	12	10,50
4502231	40 25345 02231 5	80	5	12	7,50
4507458	40 25345 06545 9	100	4	12	6,00
4507459*	40 25345 06546 6	120	3	14	4,50
4515842*	40 25345 11683 0	140	3	14	4,50

\* on request

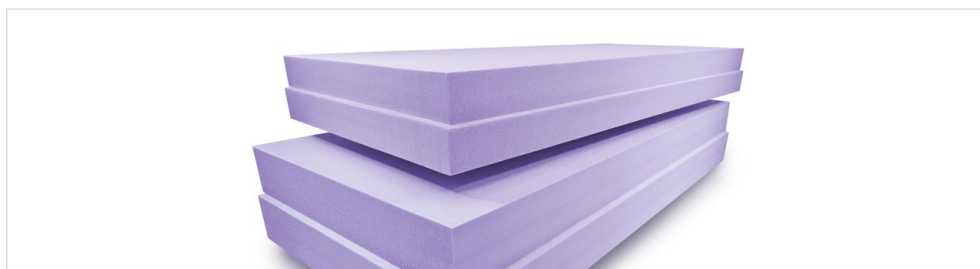

## JACKODUR® KF 500 Standard SF

Art. no.	EAN code	Thickness mm	Boards per pack	Packs per pallet	m <sup>2</sup> / pack
4502772*	40 25345 02772 3	40	10	12	7,50
4502773*	40 25345 02773 0	50	8	12	6,00
4502774*	40 25345 02774 7	60	7	12	5,25
4502775	40 25345 02775 4	80	5	12	3,75
4502946	40 25345 02946 8	100	4	12	3,00
4502947	40 25345 02947 5	120	3	14	2,25

- Boards with 15 mm shiplap all-round for heavy-duty applications when insulating perimeters, flat roofs, parking decks, beneath industrial floors, etc.
- Smooth, extrusion-compressed surface
- Compressive strength 500 kPa
- Format 1265 x 615 mm, covering area 1250 x 600 mm = 0.75 m<sup>2</sup>

4502948*	40 25345 02948 2	140	3	12	2,25
4504076	40 25345 04076 0	160	3	10	2,25
4502979*	40 25345 02979 6	180	2	14	1,50
4502980	40 25345 02980 2	200	2	12	1,50
4502981*	40 25345 02981 9	220	2	12	1,50
4502982*	40 25345 02982 6	240	2	10	1,50
4516241*	40 25345 11897 1	260	2	10	0,75
4516246*	40 25345 11902 2	280	2	10	0,75
4516235*	40 25345 11891 9	300	1	18	0,75
4516234*	40 25345 11890 2	320	1	16	0,75

\* on request

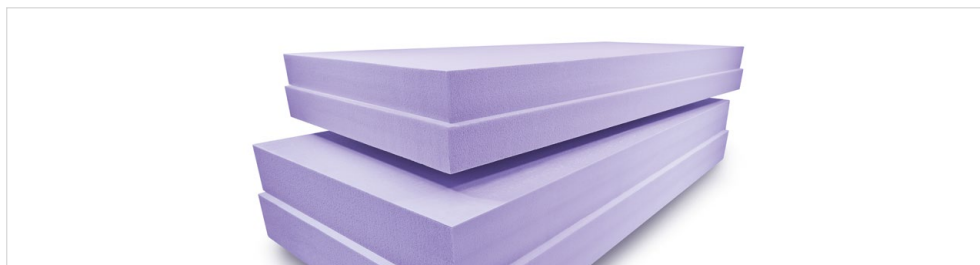

## JACKODUR® KF 700 Standard SF

Art. no.	EAN code	Thickness mm	Boards per pack	Packs per pallet	m <sup>2</sup> / pack
4504060*	40 25345 04060 9	50	8	12	6,00
4504061*	40 25345 04061 6	60	7	12	5,25
4502987*	40 25345 02987 1	80	5	12	3,75
4502988	40 25345 02988 8	100	4	12	3,00
4502989	40 25345 02989 5	120	3	14	2,25

- Boards with 15 mm shiplap all-round for extremely heavy-duty applications when insulating perimeters, flat roofs, parking decks, beneath industrial floors, etc.
- Smooth, extrusion-compressed surface
- Compressive strength 700 kPa
- Format 1265 x 615 mm, covering area 1250 x 600 mm = 0.75 m<sup>2</sup>

4502990*	40 25345 02990 1	140	3	12	2,25
4502991*	40 25345 02991 8	160	3	10	2,25
4502992*	40 25345 02992 5	180	2	14	1,50
4502993*	40 25345 02993 2	200	2	12	1,50
4502994*	40 25345 02994 9	220	2	12	1,50
4502995*	40 25345 02995 6	240	2	10	1,50
4516242*	40 25345 11898 8	260	2	10	0,75
4516245*	40 25345 11901 5	280	2	10	0,75
4516236*	40 25345 11892 6	300	1	18	0,75
4516237*	40 25345 11893 3	320	1	16	0,75

\* on request

# Cold bridge insulation

## JACKODUR® Foundation shuttering

- Two functions in one product: Formwork and thermal bridge insulation
- Quick and cost-efficient to install
- Sturdy, compression proof
- Rot resistant
- No thermal bridges
- Each element with 4 integrated pipe sleeves, internal diameter approx. 13 mm
- Smooth, extrusion-compressed surface



Art. no.	EAN code	Thickness mm	Height mm	Length mm	Type	Pack cont. boards
4502926*	40 25345 02926 0	50	500	1250	K I F 50	8
4500909*	40 25345 00909 5	50	600	1250	K I F 60	8

\* on request

## JACKODUR® Rendering edging strips

- Edging finish for window and door openings in cavity walls or in the gable end area
- Structured surface can be rendered on directly
- Width (textured side) corresponds to distance between wall and facing bricks

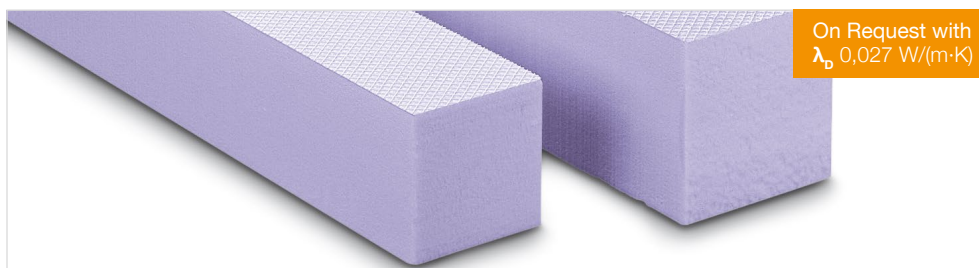

Art. no.	EAN code	Thickness mm	Height mm	Length mm	Pcs./pallet	m/pallet
4500163*	40 25345 00163 1	60	60	1250	700	875,0
4500093*	40 25345 00093 1	60	80	1250	490	612,5
4500173*	40 25345 00173 0	60	100	1250	420	525,0
4500092*	40 25345 00092 4	60	120	1250	350	437,5

4500172*	40 25345 00172 3	80	80	1250	350	437,5
4500090*	40 25345 00090 0	80	100	1250	300	375,0
4500170*	40 25345 00170 9	80	120	1250	250	312,5
4500957	40 25345 00957 6	80	140	1250	200	250,0
4504155	40 25345 04155 2	80	160	1250	150	187,5
4505907	40 25345 05484 2	80	180	1250	150	187,5
4506533*	40 25345 05906 9	80	200	1250	150	187,5

4500091*	40 25345 00091 7	100	100	1250	240	300,0
4500171*	40 25345 00171 6	100	120	1250	200	250,0
4501774*	40 25345 01774 8	100	140	1250	160	200,0
4500891*	40 25345 00891 3	100	150	1250	160	200,0
4509333*	40 25345 07876 3	100	200	1250	120	150,0

4500085*	40 25345 00085 6	120	120	1250	150	187,5
4500961*	40 25345 00961 3	120	140	1250	120	150,0
4502333*	40 25345 02333 6	120	150	1250	120	150,0
4505067*	40 25345 05067 7	120	160	1250	90	112,5
4505068*	40 25345 05068 4	120	180	1250	90	112,5
4505069*	40 25345 05069 1	120	200	1250	90	112,5

\* on request

Minimum order: 1 pallet = 10 packages



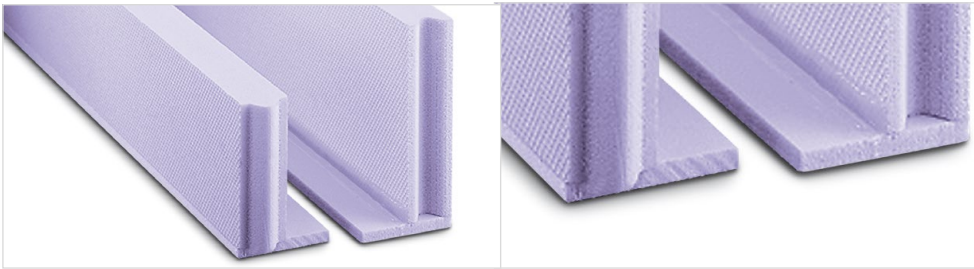

## JACKODUR® Insulation shuttering JDS

Art. no.	EAN code	Thickness mm	Height mm	Length mm	Pcs./pallet	m/pallet
4500022*	40 25345 00022 1	35	160	1250	160	200
4500115*	40 25345 00115 0	35	180	1250	160	200
4500474*	40 25345 00474 8	35	200	1250	128	160
4500101*	40 25345 00101 3	35	220	1250	128	160
4500023*	40 25345 00023 8	35	250	1250	128	160

4500099*	40 25345 00099 3	50	160	1250	160	200
4500021*	40 25345 00021 4	50	180	1250	160	200
4500114*	40 25345 00114 3	50	200	1250	128	160
4500007*	40 25345 00007 8	50	220	1250	128	160
4500100*	40 25345 00100 6	50	250	1250	128	160

4502330*	40 25345 02330 5	60	160	1250	120	150
4502115*	40 25345 02115 8	60	180	1250	128	160
4502116*	40 25345 02116 5	60	200	1250	96	120
4502331*	40 25345 02331 2	60	220	1250	96	120
4502332*	40 25345 02332 9	60	250	1250	96	120

\* on request

Minimum purchase 1 pallet



## JACKODUR® Insulation shuttering Plus

Art. no.	EAN code	Thickness mm	Height mm	Length mm	Pcs./pallet	m/pallet
4509122*	40 25345 07735 3	60	160	1250	120	150
4509123*	40 25345 07736 0	60	180	1250	128	160
4509124*	40 25345 07737 7	60	200	1250	96	120
4509125*	40 25345 07738 4	60	220	1250	96	120
4509126*	40 25345 07739 1	60	250	1250	96	120

\* on request

Minimum purchase 1 pallet

- Floor edge formwork, thermal insulation and plaster base combined into one product
- Element made entirely of high quality XPS
- Simple tongue and groove installation
- Additional fastening or back support required for heights of 200 mm or more
- No need to remove the formwork
- Total base width for 35 mm thickness = 70 mm and for 50 and 60 mm thickness = 100 mm
- Available with company imprint on request

- Element with superb insulating properties  $\lambda_D = 0,027 \text{ W/(m}\cdot\text{K)}$
- You only need 60 mm to replace conventional 80 mm XPS
- Up to 25% improved insulating performance
- Total base width = 100 mm

# Cold bridge insulation

## JACKODUR® Insulation Strip

- no thermal bridges
- easy to work with
- price advantage compared to roof battens
- thermal conductivity = 0.035 W/(m·K) up to 60 mm insulation strip thickness



Art. no.	EAN code	Thickness mm	Height mm	Length mm	Pcs./box
4507809*	40 25345 06757 6	30	60	1250	70
4507810*	40 25345 06758 3	60	60	1250	35
4507811*	40 25345 06759 0	80	60	1250	25

\* on request  
Minimum order: 1 box  
Further dimensions available on request

## JACKODUR® Angle fillet

- Insulation angle fillet for flat roofs
- Chamfered corners in accordance with DIN 18195
- Improved sealing sheet joining technology



Art. no.	EAN code	Thickness mm	Length mm	Pcs./pack	m/pack
4504085*	40 25345 04085 2	50/50	1250	60	75,00
4504086*	40 25345 04086 9	60/60	1250	40	50,00
4504087*	40 25345 04087 6	80/80	1250	25	31,25

\* on request

## JACKODUR® Cavity tray insulation

- Special sloped insulation to carry membranes for cavity trays
- Moisture is drained automatically through the fall (DIN 1053)
- Tongue and groove connection for a cold bridge free insulating

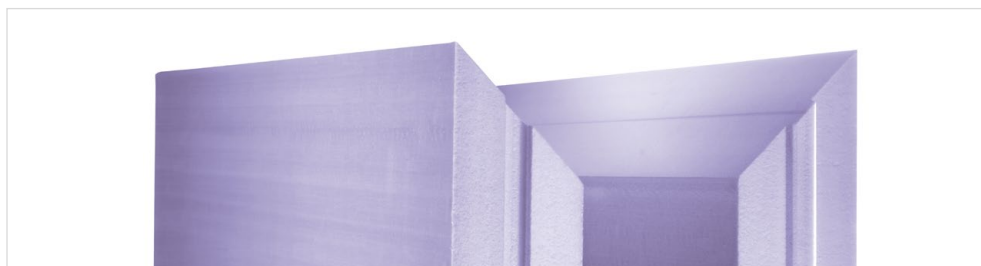

Art. no.	EAN code	Thickness mm	Height mm	Length mm	Pcs./pack	m/pack
4504081*	40 25345 04081 4	80	250/350	1250	10	12,50
4504082*	40 25345 04082 1	100	250/350	1250	8	10,00
4504083*	40 25345 04083 8	120	250/350	1250	6	7,50
4504084*	40 25345 04084 5	140	250/350	1250	6	7,50
4508475*	40 25345 07244 0	160	250/350	1250	6	7,50
4510256*	40 25345 08472 6	180	250/350	1250	6	7,50
4512281*	40 25345 09803 7	200	250/350	1250	4	5,00

\* on request  
Minimum order 1 pack



Art. no.	EAN code	Volume ml	Piece
4514799	40 25345 11065 4	750	1

Minimum order: 1 piece  
12 piece/box, 52 boxes/palette

## JACKODUR® Perimeter adhesive foam

- Solvent-free single-component polyurethane adhesive
- Secure bonding of JACKODUR® thermal insulation
- Seals joints and recesses in the insulating layer without leaving thermal bridges
- Thermal conductivity 0,0354 W/(m·K)
- Processing temperature: from +35C to -5C
- Supplied with adapter hose
- Excellent adhesion on many substrates
- 1 tube gives 16 m<sup>2</sup>



Art. no.	EAN code	Volume ml	Pcs./box
4510610	40 25345 08725 3	310	12

## JACKODUR® Assembly adhesive

- Solvent-free PU-based adhesive
- Very high ultimate strength
- For gluing JACKODUR® and JACKOBOARD®
- Very fast curing
- 1 tube gives 10 linear metres



Art. no.	EAN code	Length m	Width m
4501712	40 25345 01712 0	100	3

## JACKODUR® Filter layer WA

- Water-flow reducing layer for inverted roofs
- Waterproof but water vapour permeable
- Fabric weight appr. 100 g/m<sup>2</sup>
- Fire resistance Euroclass E
- UV stable

# Insulation system for floor plates

JACKODUR®  
Atlas

JACKODUR® Atlas is an insulation system for floor plates. Its intelligent joining technology creates a sturdy composite insulation system that eliminates the need to brace the floor plate at the sides. Insulation and formwork application in

one and the same step. JACKODUR® Atlas allows you to create floor plates that are free of thermal bridges and with different insulation thicknesses and compressive strengths to suit your individual requirements.

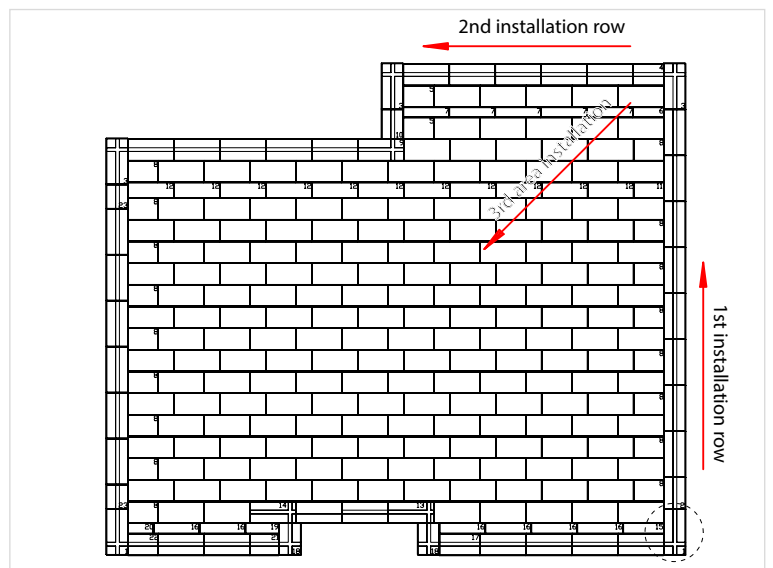
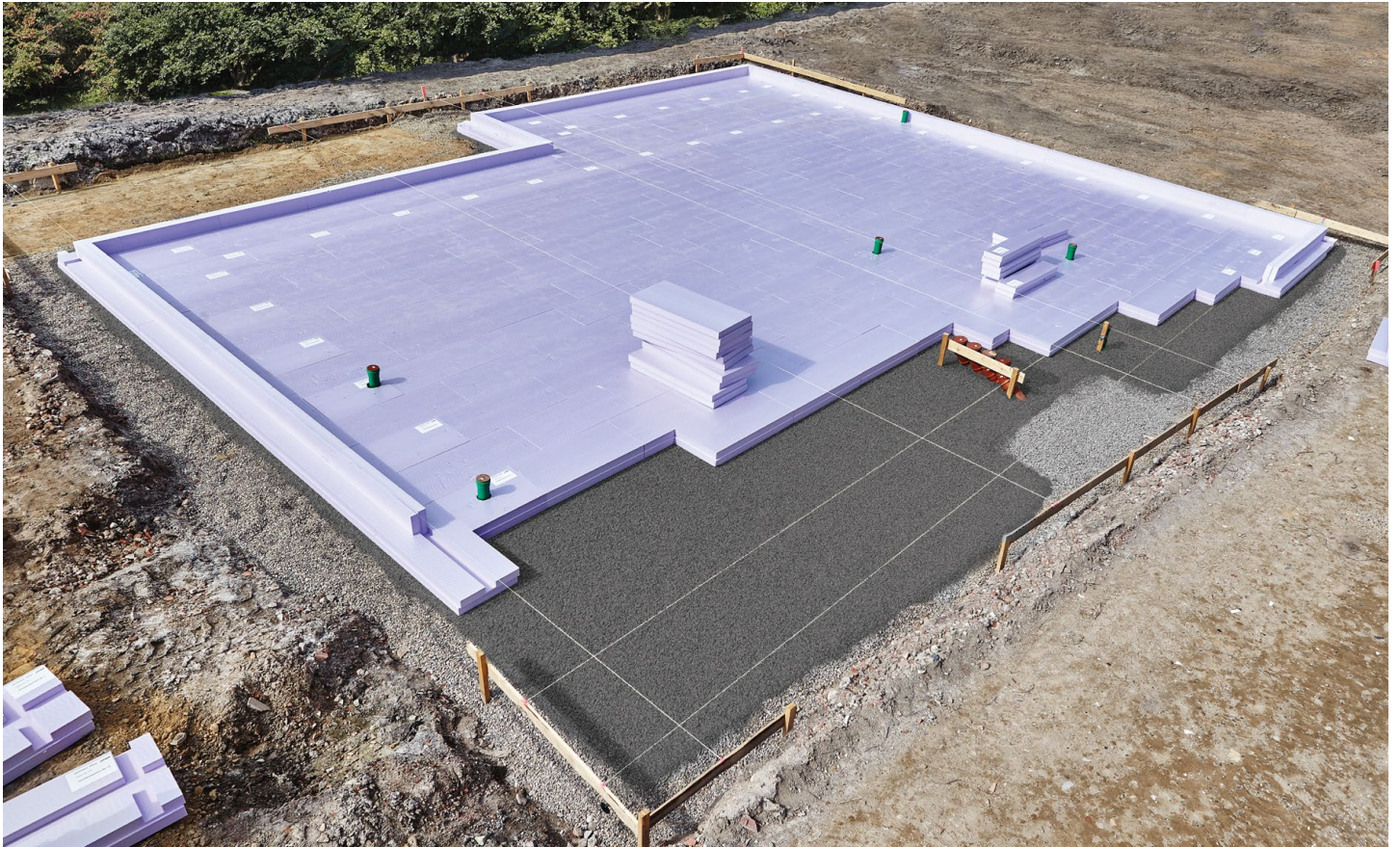

You receive an installation plan that shows where the tailor-made insulation elements (special elements) have to be positioned

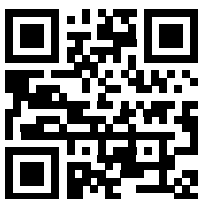

Scan the code for demonstration films  
<https://youtu.be/ZbNfySKcHIA>

# Insulation system for floor plates

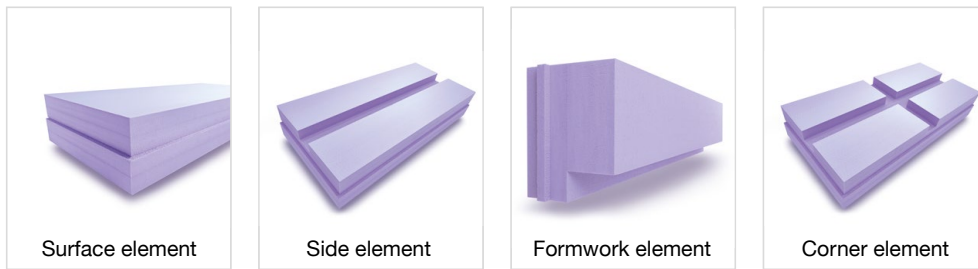

JACKODUR®  
Atlas

## Formwork element

- Formwork element with tongue for insertion into the Atlas corner and side element
- Insulation thicknesses from 80 – 320 mm for floor plate heights up to 500 mm

## Surface element

- Surface element for Atlas
- Insulation thicknesses from 100 – 320 mm

## Corner element

- With groove for mounting the Atlas formwork element
- Insulation thicknesses from 100 – 320 mm

## Side element

- With groove for mounting the Atlas formwork element
- Insulation thicknesses from 100 – 320 mm

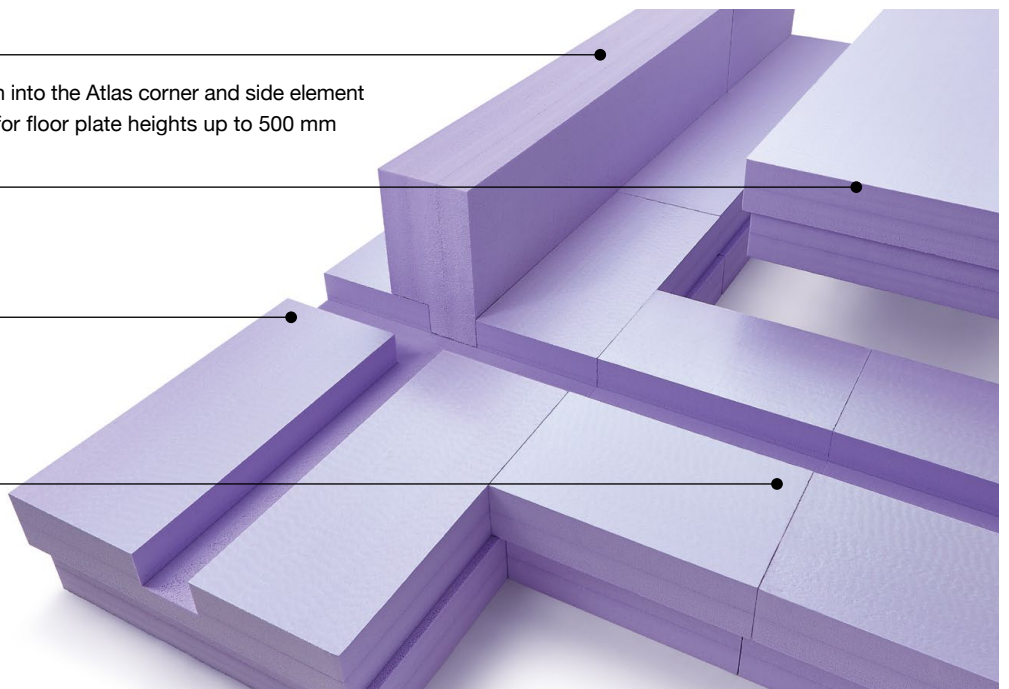

## JACKODUR® Atlas price enquiry

We need the following information to compile your quote:

We need a layout plan of the floor plate when you will order the JACKODUR® Atlas system.  
Please contact us if you require further details or customized solutions.

To the  
online form  
[www.jackon-insulation.com](http://www.jackon-insulation.com)

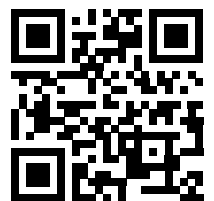

**1 Thickness of formwork element (mm)**  
(Thickness of side insulation)

**2 Height of formwork element (mm)**  
(Thickness of floor plate)

**3 Thickness of surface element (mm)**  
(Insulation thickness beneath floor plate)

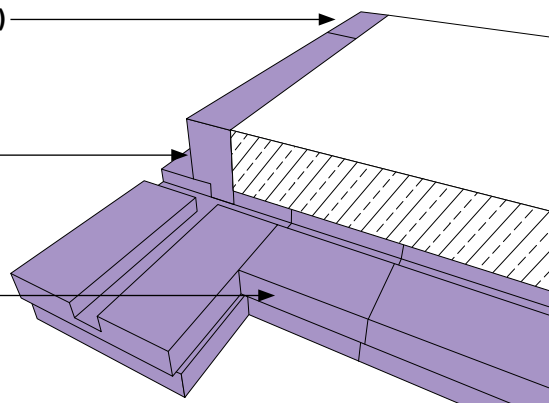

**4 Floor plate area (m<sup>2</sup>)**  
(external floor plate dimensions, excluding insulation)

**5 Floor plate circumference (m<sup>2</sup>)**  
(external floor plate dimensions, excluding insulation)

**6 Number of 90° corners (piece)**

# JACKODUR® Technical data

Extruded polystyrene foam (XPS) according to EN 13164

Properties	Symbol	Declaration/ Unit	Standard
Density		kg/m <sup>3</sup>	EN 1602
Thermal conductivity	$\lambda_b$	W/(m·K)	EN 13164
Thickness tolerance	Ti	Class	EN 823
Dimensional stability at 70°C and 90% relative humidity	DS(70/90)	%	EN 1604
Compressive stress at 10% deformation or compressive	CS(10\Y)i	Level i kPa <sup>3</sup>	EN 826
Reaction to fire	-	Class	EN 13501-1
Deformation under 40 kPa load and 70°C	DLT(2)5	%	EN 1605
Tensile strength	TRi	Level i kPa <sup>3</sup>	EN 1607
Compressive creep (50 years, deformation < 2%)	CC(2/1,5/50) $\sigma_c$	$\sigma_c$ in kPa <sup>3</sup>	EN 1606
Long term water absorption by total immersion	WL(T)i	Level i %	EN 12087
Long term water absorption by diffusion <sup>1</sup>	WD(V)i	Class	EN 12088
Freeze-thaw resistance	FTCDi	Class	EN 12091
Water vapour diffusion resistance factor <sup>1</sup>	$\mu$	-	EN 12086
Coefficient of linear thermal expansion	-	mm/(m·K)	-
Maximum working temperature	-	°C	-
Surface	-	-	-
Possible edge profiles	-	-	-

<sup>1</sup> depending on thickness

<sup>2</sup> at thickness 20 mm: 200 kPa

<sup>3</sup> 100 kPa = 100 kN/m<sup>2</sup> = 0,1 N/mm<sup>2</sup>

Thickness mm	Plus 300 Standard		Plus 300 Gefiniert		KF 300 Standard		KF 300 Gefiniert		KF 500 Standard		KF 700 Standard	
	$\lambda_D$	$R_D$	$\lambda_D$	$R_D$	$\lambda_D$	$R_D$	$\lambda_D$	$R_D$	$\lambda_D$	$R_D$	$\lambda_D$	$R_D$
	> 33		> 33		> 30		> 30		> 35		> 38	
20	-	-	-	-	0,034	0,55	0,034	0,55	-	-	-	-
30	-	-	-	-	0,034	0,85	0,034	0,85	-	-	-	-
40	-	-	-	-	0,034	1,15	0,034	1,15	0,034	1,15	-	-
50	0,027	1,85	0,027	1,85	0,034	1,45	0,034	1,45	0,034	1,45	0,034	1,45
60	0,027	2,20	0,027	2,20	0,034	1,75	0,034	1,75	0,034	1,75	0,034	1,75
80	0,027	2,95	0,027	2,95	0,035	2,25	0,035	2,25	0,035	2,25	0,035	2,25
100	0,027	3,70	0,027	3,70	0,035	2,85	0,035	2,85	0,035	2,85	0,035	2,85
120	0,027	4,40	0,027	4,40	0,035	3,40	0,035	3,40	0,035	3,40	0,035	3,40
140	0,027	5,15	0,027	5,15	0,035	4,00	0,035	4,00	0,035	4,00	0,035	4,00
160	0,027	5,90	0,027	5,90	0,035	4,55	0,035	4,55	0,035	4,55	0,035	4,55
180	0,027	6,65	0,027	6,65	0,035	5,10	0,035	5,10	0,035	5,10	0,035	5,10
200	0,027	7,40	0,027	7,40	0,036	5,55	0,036	5,55	0,035 <sup>NEW</sup>	5,70 <sup>NEW</sup>	0,035 <sup>NEW</sup>	5,70 <sup>NEW</sup>
220	0,027	8,10	-	-	0,036	6,10	0,036	6,10	0,035 <sup>NEW</sup>	6,25 <sup>NEW</sup>	0,035 <sup>NEW</sup>	6,25 <sup>NEW</sup>
240	0,027	8,85	-	-	0,036	6,65	0,036	6,65	0,035 <sup>NEW</sup>	6,85 <sup>NEW</sup>	0,035 <sup>NEW</sup>	6,85 <sup>NEW</sup>
260	0,027	9,60	-	-	0,036	7,20	0,036	7,20	0,035 <sup>NEW</sup>	7,40 <sup>NEW</sup>	0,035 <sup>NEW</sup>	7,40 <sup>NEW</sup>
280	0,027	10,35	-	-	0,036	7,75	0,036	7,75	0,035 <sup>NEW</sup>	8,00 <sup>NEW</sup>	0,035 <sup>NEW</sup>	8,00 <sup>NEW</sup>
300	0,027	11,10	-	-	0,036	8,30	0,036	8,30	0,035 <sup>NEW</sup>	8,55 <sup>NEW</sup>	0,035 <sup>NEW</sup>	8,55 <sup>NEW</sup>
320	0,027	11,85	-	-	0,036	8,85	0,036	8,85	0,035 <sup>NEW</sup>	9,10 <sup>NEW</sup>	0,035 <sup>NEW</sup>	9,10 <sup>NEW</sup>
	T1		T1		T1		T1		T1		T1	
	≤ 5		≤ 5		≤ 5		≤ 5		≤ 5		≤ 5	
	300		300		300 <sup>2</sup>		300 <sup>2</sup>		500		700	
	Euroclass E											
	≤ 5		≤ 5		≤ 5		≤ 5		≤ 5		≤ 5	
	-		200		-		200		-		-	
	130		-		130		-		180		250	
	0,7		-		0,7		-		0,7		0,7	
	WD(V)1-3		-		WD(V)1-3		-		WD(V)1-3		WD(V)1-3	
	FTCD1		-		FTCD1		-		FTCD1		FTCD1	
	250-80		250-80		250-80		250-80		250-80		250-80	
	0,07		0,07		0,07		0,07		0,07		0,07	
	+75 °C		+75 °C		+75 °C		+75 °C		+75 °C		+75 °C	
	skin		structured		skin		structured		skin		skin	
	shiplap		butt edge		butt edge, shiplap, tongue and groove		butt edge		shiplap		shiplap	

#### Important notes:

JACKODUR® products are suitable for continuous use at maximum temperatures of up to +75°C. On days with exposure to intense sunlight, care must be taken to ensure that the JACKODUR® products are not covered with dark layers (e.g. waterproofing elements, non-woven materials, mats). Any heat build-up can lead to deformation of the thermal insulation boards and therefore must be avoided.

JACKODUR® products cannot withstand continuous exposure to sunlight (UV radiation) and their surface must be protected from weathering.

Contact with volatile substances (e.g. Solvents) and solvent-containing adhesives must be avoided.

Because JACKODUR® products offer a wide range of application options, suppliers cannot always monitor them for proper compliance with processing instructions, handling and installation. As a result, JACKON Insulation GmbH is liable only for the data named here in accordance with licensing regulations.

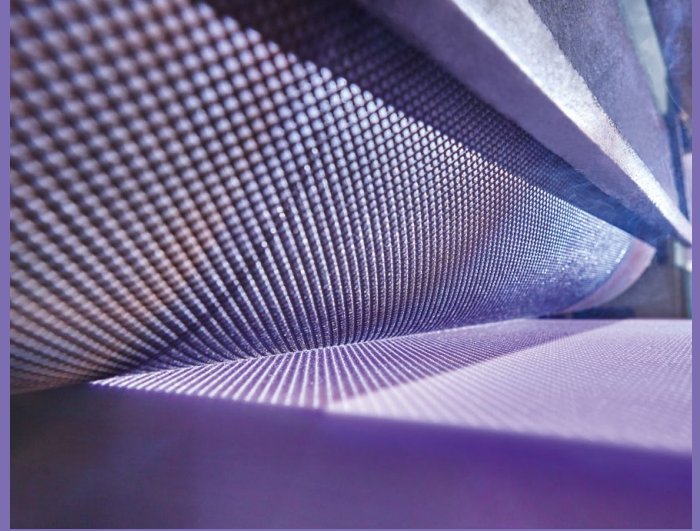

For customers from the UK and Ireland

Tel: +44 (0) 1204 221089

Fax: +44 (0) 1942 253711

JACKON Insulation GmbH

Carl-Benz-Straße 8

D-33803 Steinhagen

Tel: +49 (0) 5204 99 55-444

Fax: +49 (0) 5204 99 55-300

E-Mail: [info@jackodur.com](mailto:info@jackodur.com)

[www.jackon-insulation.co.uk](http://www.jackon-insulation.co.uk)

Your dealer:

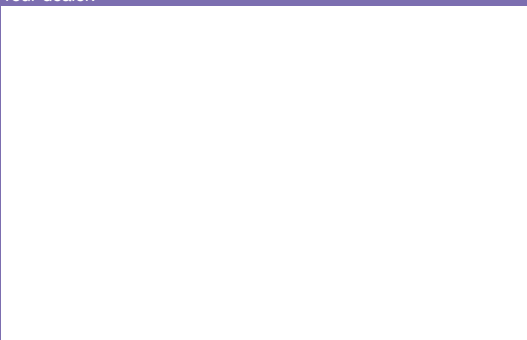

Reg.-Nr.067674

